



SUPERIOR

IN-LINE VALVES

Model SPV

1" Model Depicted Below

NOTES:

1. Index numbers are listed in numerical order on the reference guide in the back.
2. Circular index numbers indicate that the part can be purchased separately.
3. Triangular index numbers indicate that the part is available as part of a sub-assembly or repair kit.

SUB-ASSEMBLIES & REPAIR KITS

Repair Kits (all rubber & fiber parts) -  195

Diaphragm Assembly -  199

Top Assembly -  240

Flow Control Assembly -  198

Solenoid Assembly -  18

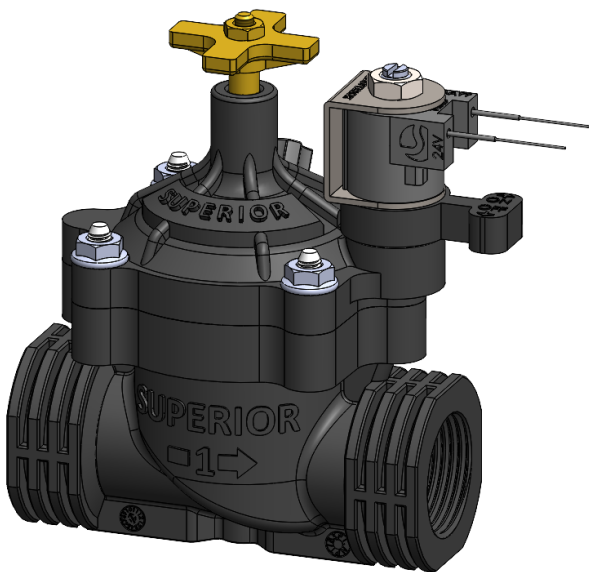
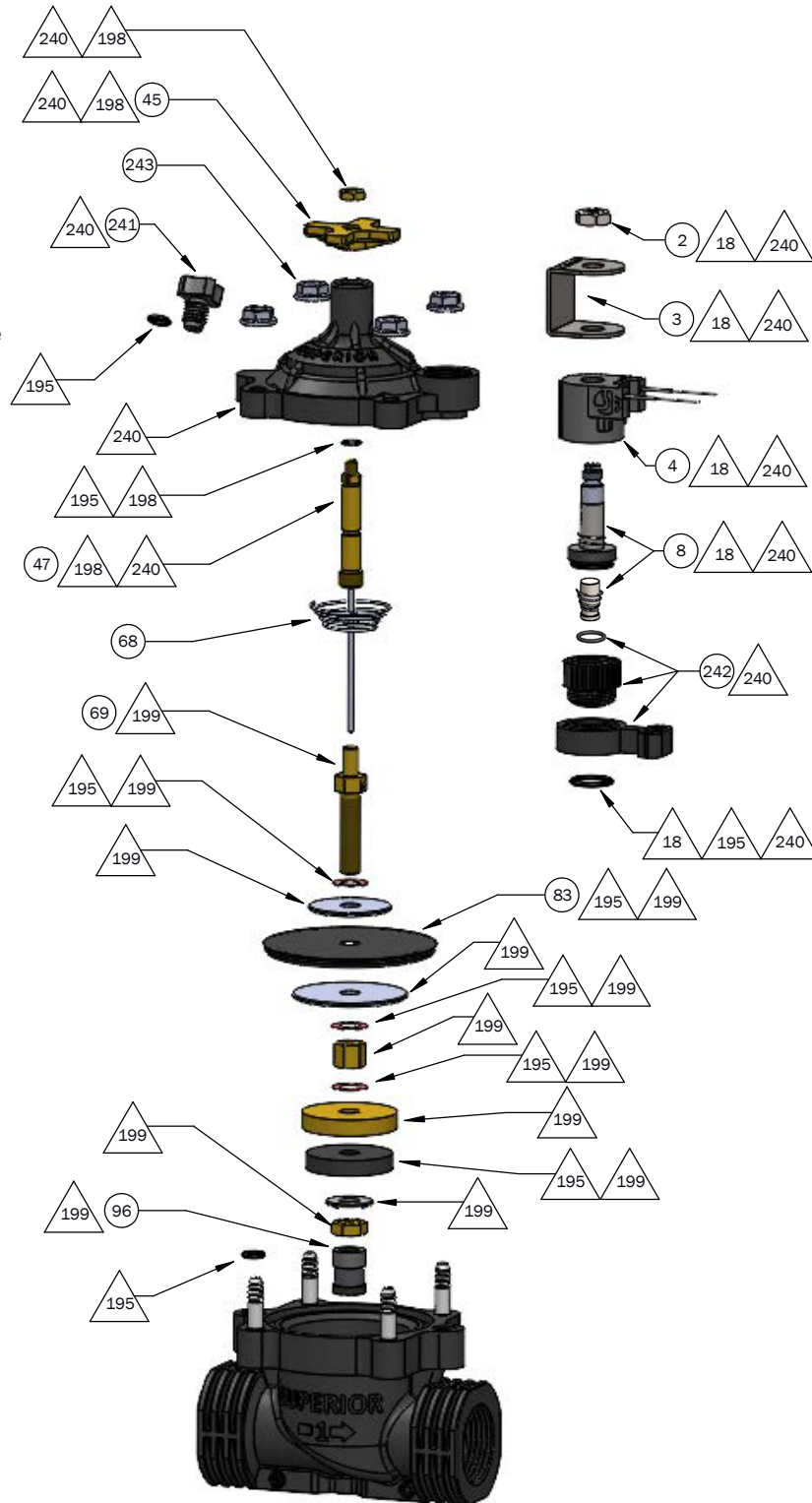



SUPERIOR

IN-LINE VALVES

Model 950

2" Model Depicted Below

NOTES:

1. Index numbers are listed in numerical order on reference guide in the back.
2. Circular index numbers indicate that the part can be purchased separately.
3. Triangular index numbers indicate that the part is available as part of a sub-assembly or repair kit.

SUB-ASSEMBLIES & REPAIR KITS

Repair Kits (all rubber & fiber parts) -  195

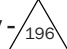
Diaphragm Assembly -  196

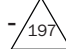
Top Assembly -  197

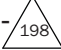
Flow Control Assembly -  198

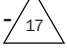
Solenoid Assembly -  17

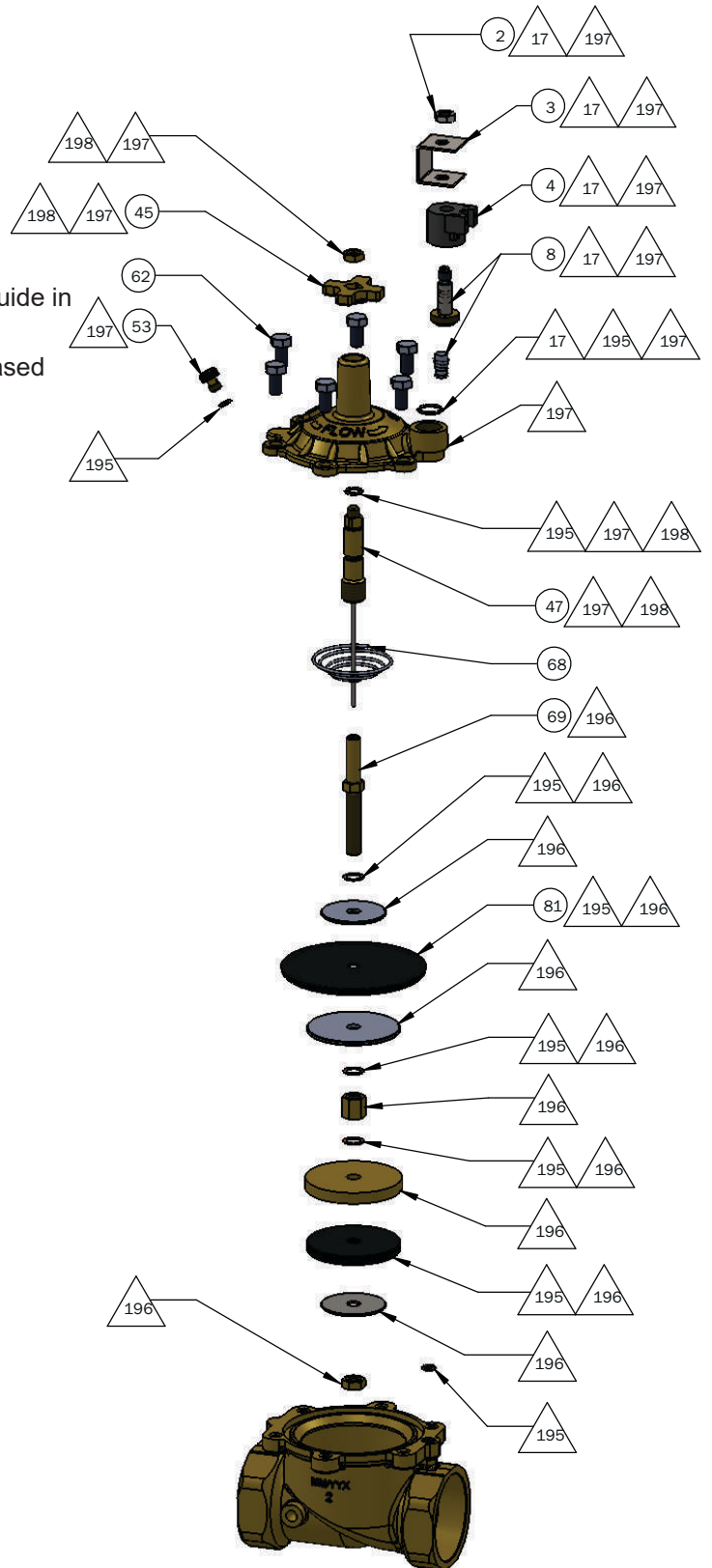
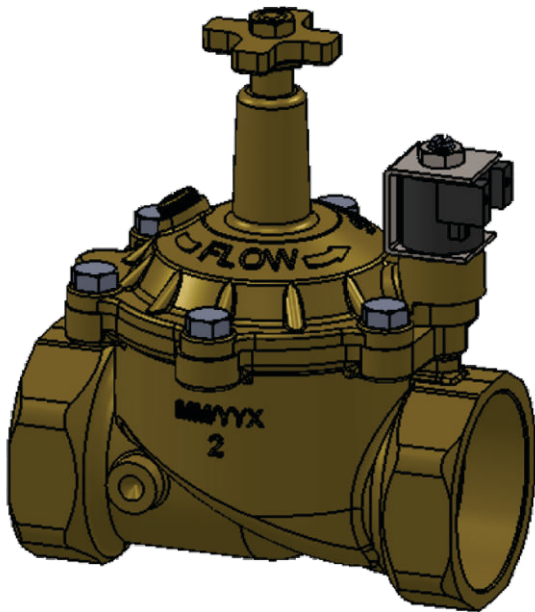



SUPERIOR

IN-LINE VALVES

Model 950DW

2" Model Depicted Below

NOTES:

1. Index numbers are listed in numerical order on reference guide in the back.
2. Circular index numbers indicate that the part can be purchased separately.
3. Triangular index numbers indicate that the part is available as part of a sub-assembly or repair kit.

SUB-ASSEMBLIES & REPAIR KITS

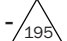
Repair Kits (all rubber & fiber parts) - 

Diaphragm Assembly - 

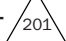
Top Assembly - 

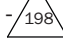
Flow Control Assembly - 

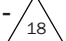
Solenoid Assembly - 

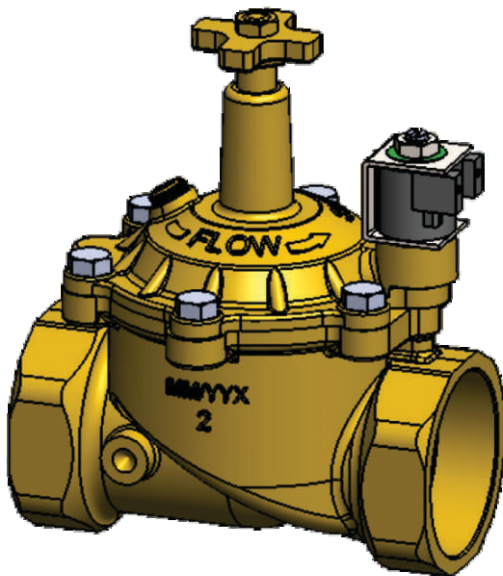
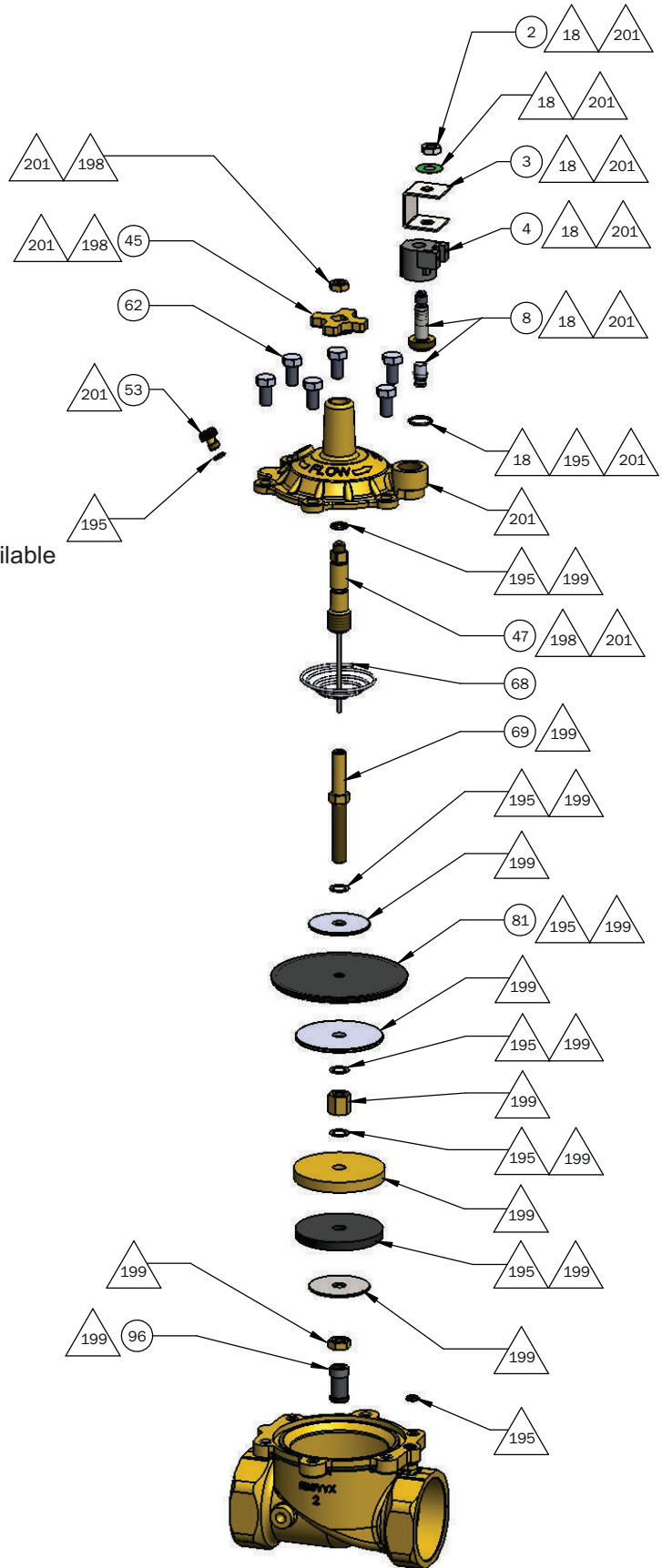



SUPERIOR

IN-LINE VALVES

Model 950DWIB

2" Model Depicted Below

NOTES:

1. Index numbers are listed in numerical order on the reference guide in the back.
2. Circular index numbers indicate that the part can be purchased separately.
3. Triangular index numbers indicate that the part is available as part of a sub-assembly or repair kit.

SUB-ASSEMBLIES & REPAIR KITS

Repair Kits (all rubber & fiber parts) - 195

Diaphragm Assembly - 199

Top Assembly - 207

Flow Control Assembly - 198

Solenoid Assembly - 18

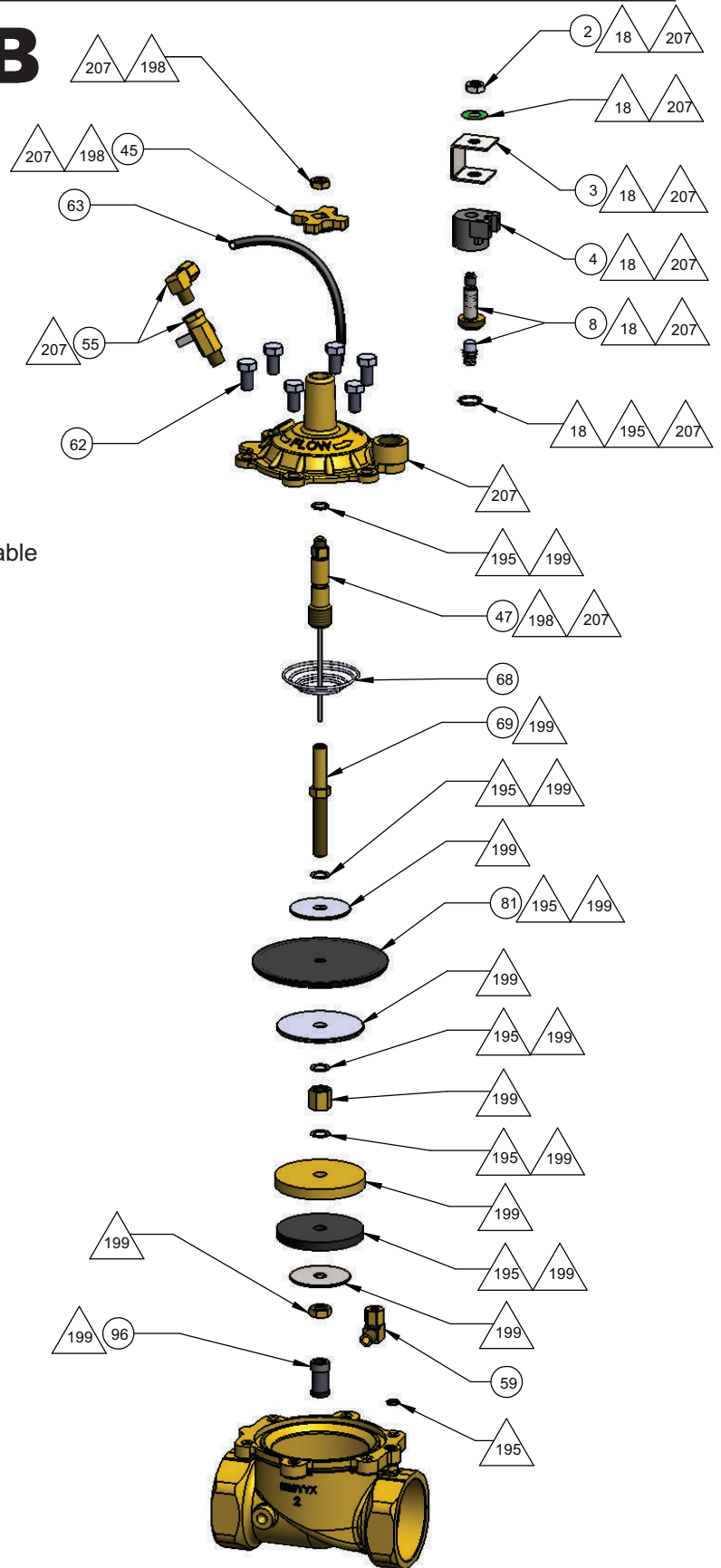
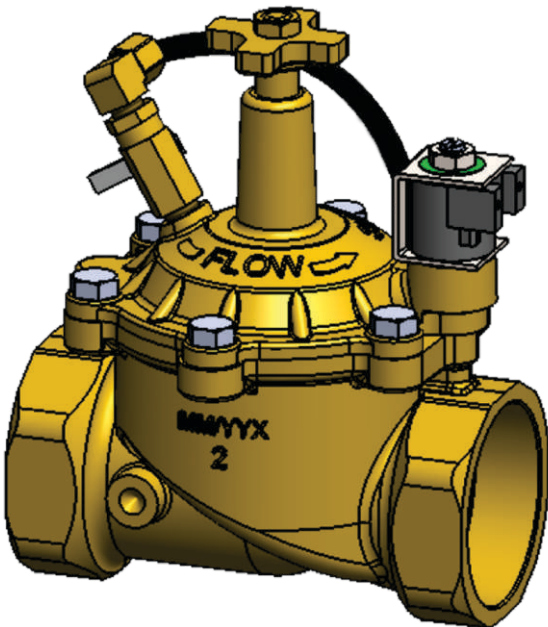



SUPERIOR

IN-LINE VALVES

Model 950SD

2" Model Depicted Below

NOTES:

1. Index numbers are listed in numerical order on reference guide in the back.
2. Circular index numbers indicate that the part can be purchased separately.
3. Triangular index numbers indicate that the part is available as part of a sub-assembly or repair kit.

SUB-ASSEMBLIES & REPAIR KITS

Repair Kits (all rubber & fiber parts) -  195

Diaphragm Assembly -  196

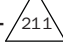
Top Assembly -  211

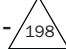
Flow Control Assembly -  198

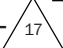
Solenoid Assembly -  17

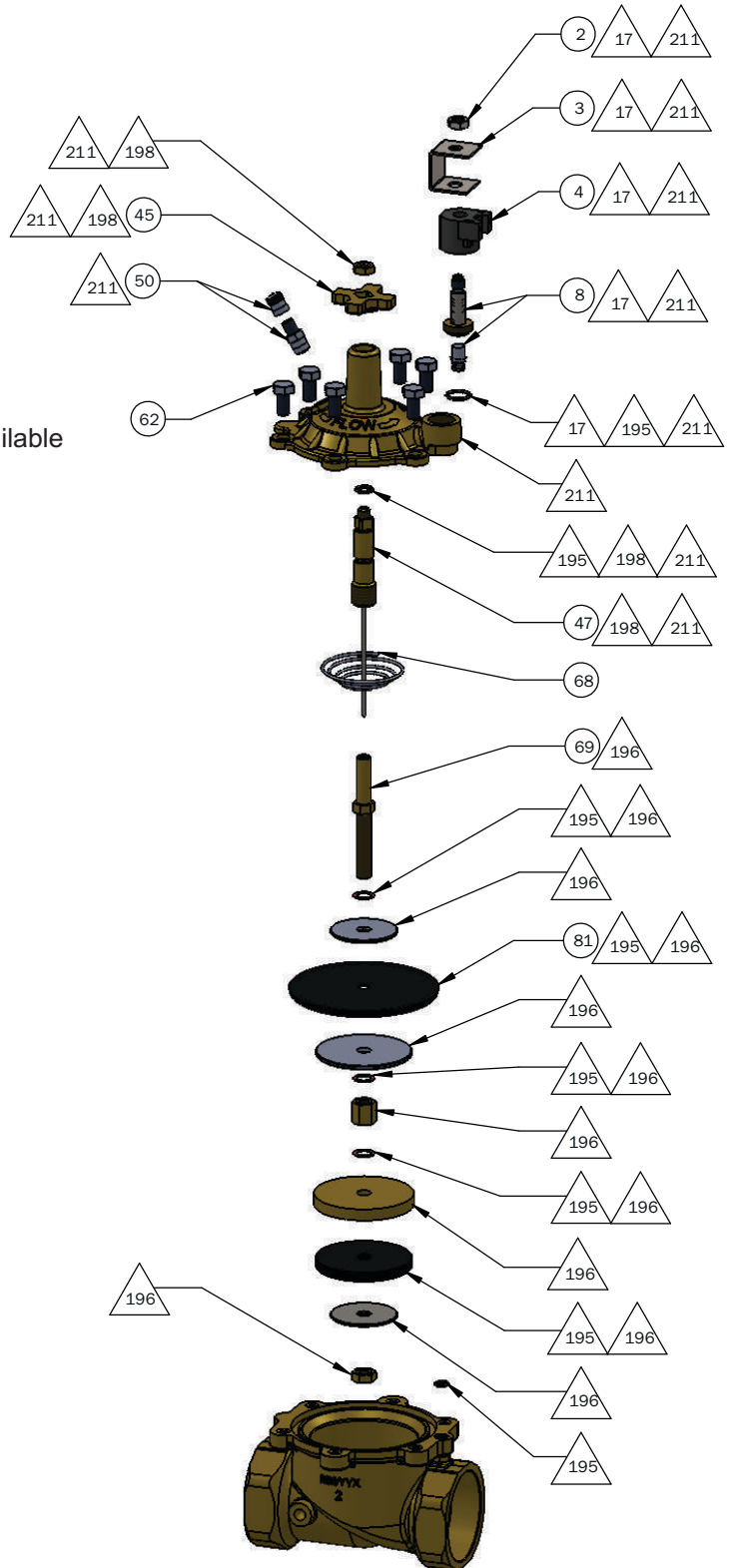
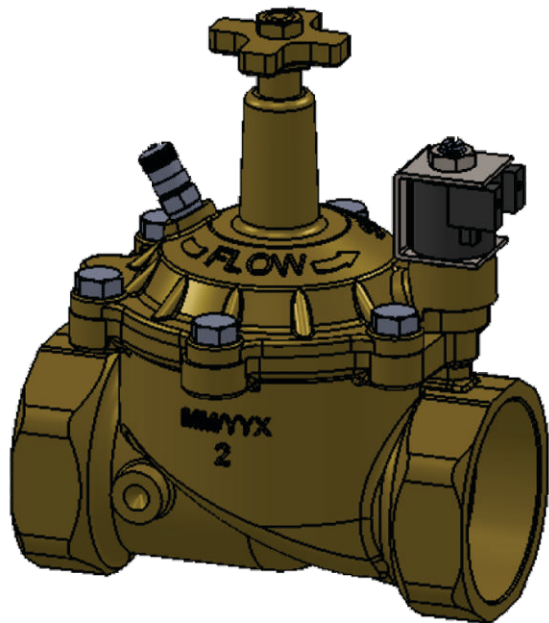



SUPERIOR

IN-LINE VALVES

Model 950SDDW

2" Model Depicted Below

NOTES:

1. Index numbers are listed in numerical order on the reference guide in the back.
2. Circular index numbers indicate that the part can be purchased separately.
3. Triangular index numbers indicate that the part is available as part of a sub-assembly or repair kit.

SUB-ASSEMBLIES & REPAIR KITS

Repair Kits (all rubber & fiber parts) -  195

Diaphragm Assembly -  199

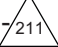
Top Assembly  211

Flow Control Assembly -  198

Solenoid Assembly -  18

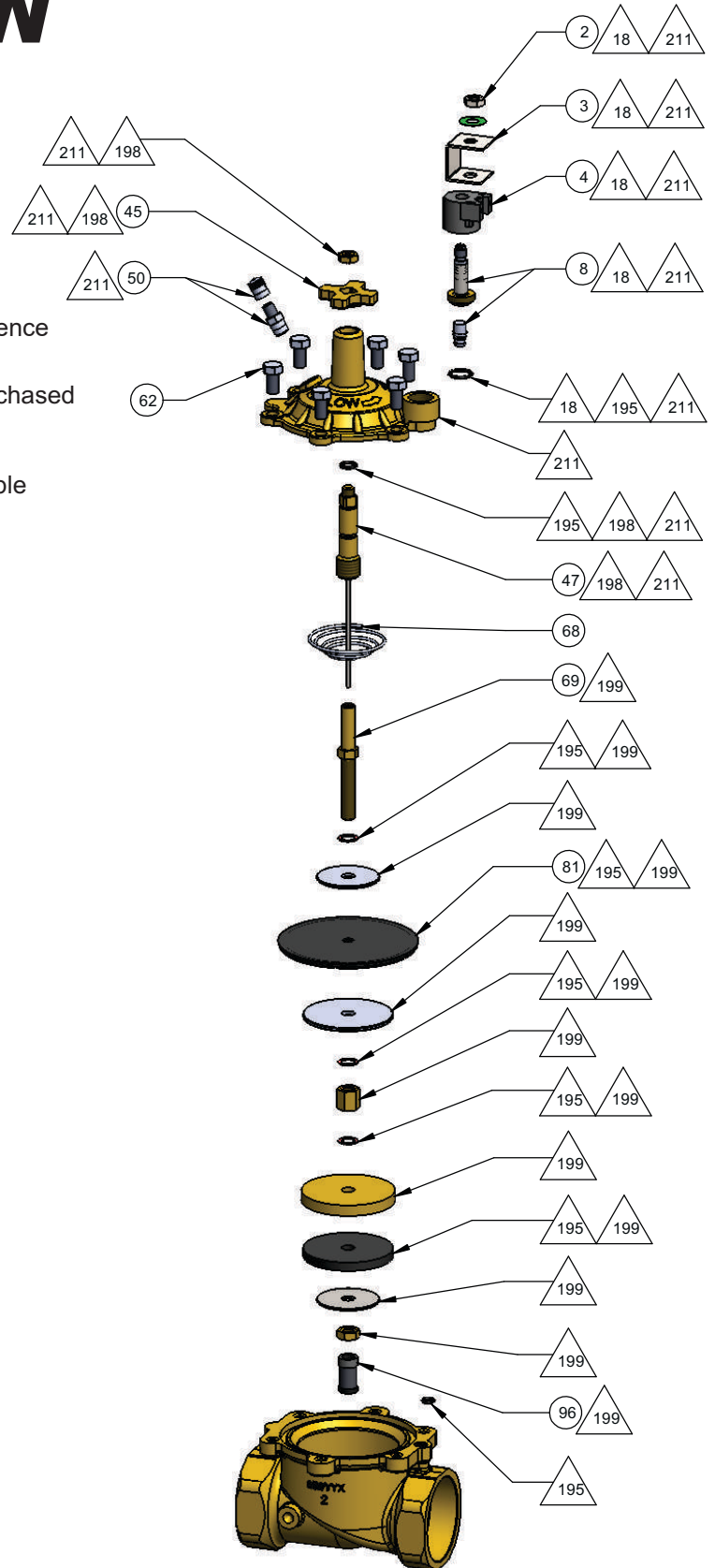
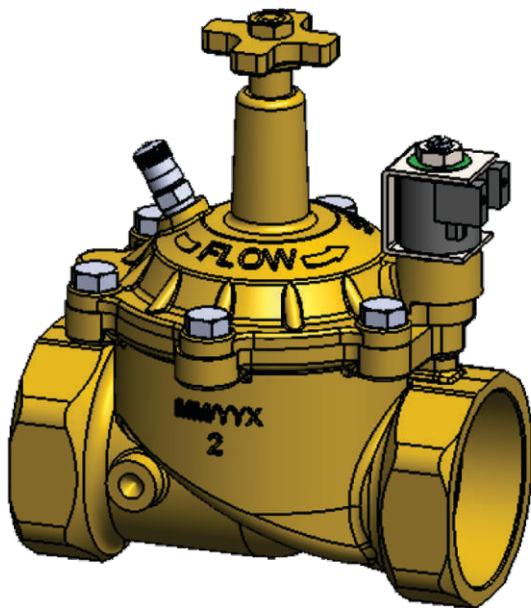



SUPERIOR

IN-LINE VALVES

Model 950PRS

2" Model Depicted Below

NOTES:

1. Index numbers are listed in numerical order on reference guide in the back.
2. Circular index numbers indicate that the part can be purchased separately.
3. Triangular index numbers indicate that the part is available as part of a sub-assembly or repair kit.

SUB-ASSEMBLIES & REPAIR KITS

Repair Kits (all rubber & fiber parts) -  195

Diaphragm Assembly -  199

Top Assembly -  202

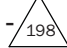
Flow Control Assembly -  198

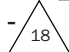
Solenoid Assembly -  18

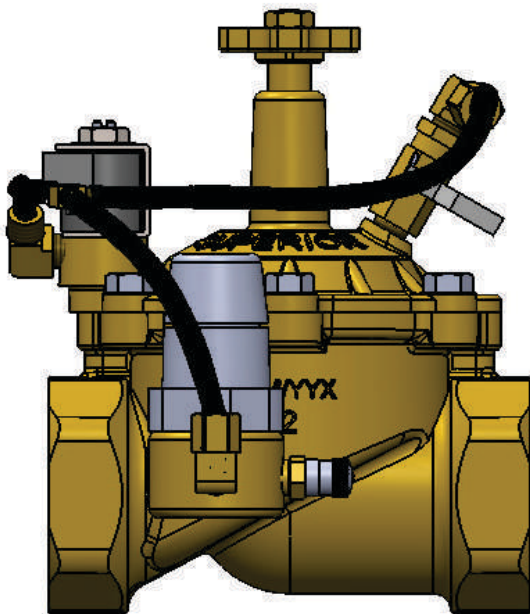
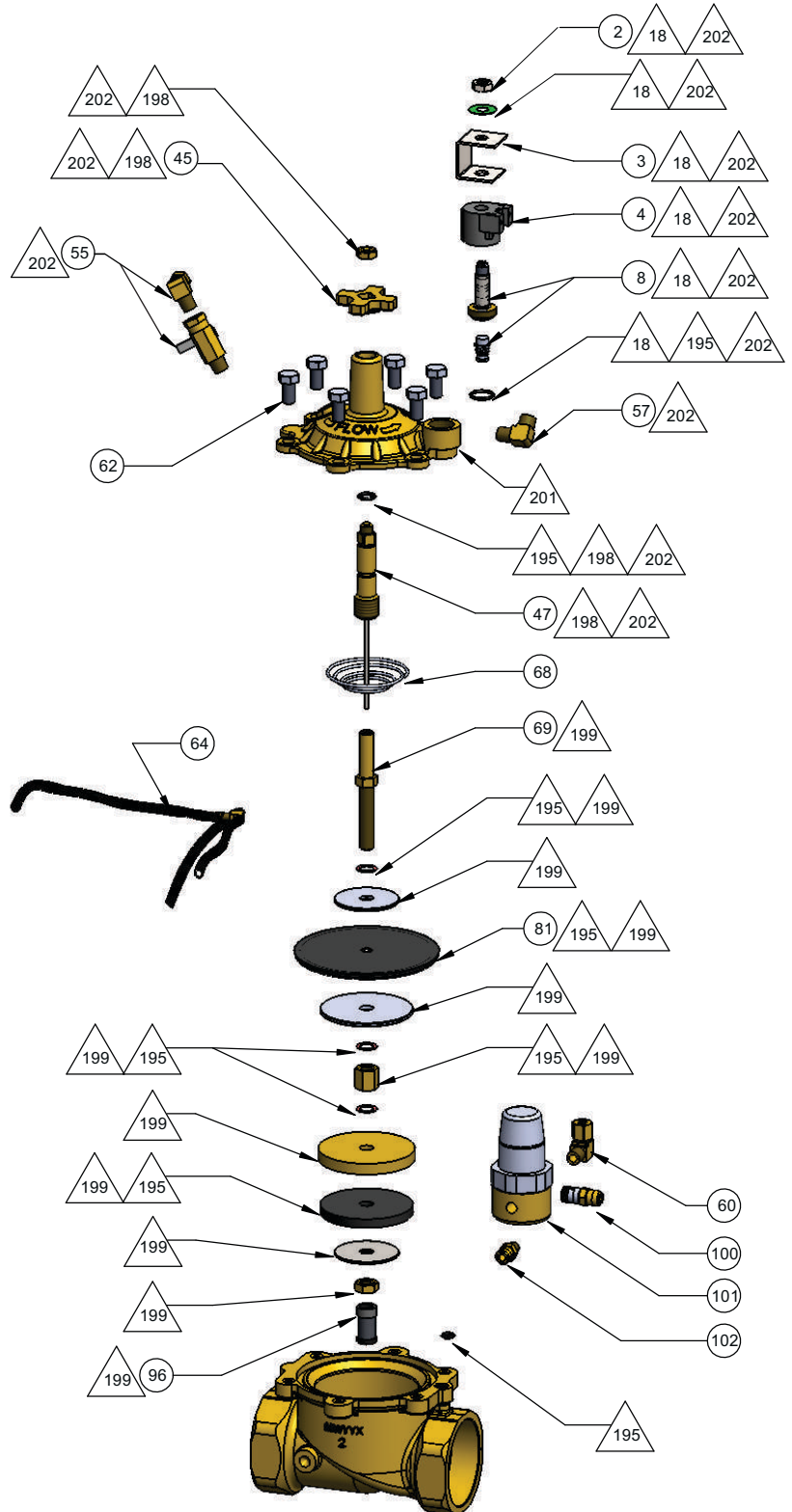



SUPERIOR

IN-LINE VALVES

Model 950A

2" Model Depicted Below

NOTES:

1. Index numbers are listed in numerical order on reference guide in the back.
2. Circular index numbers indicate that the part can be purchased separately.
3. Triangular index numbers indicate that the part is available as part of a sub-assembly or repair kit.
4. Diaphragm assembly for 1-1/2" size is the same as 2" size- 16215

SUB-ASSEMBLIES & REPAIR KITS

Repair Kits (all rubber & fiber parts) - 195

Diaphragm Assembly - 196

Top Assembly - 197

Flow Control Assembly - 198

Solenoid Assembly - 17

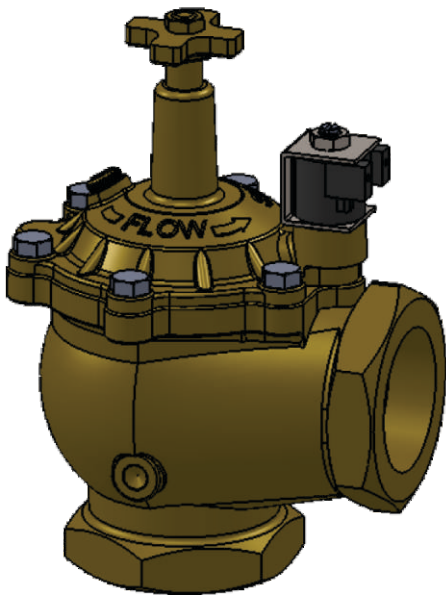
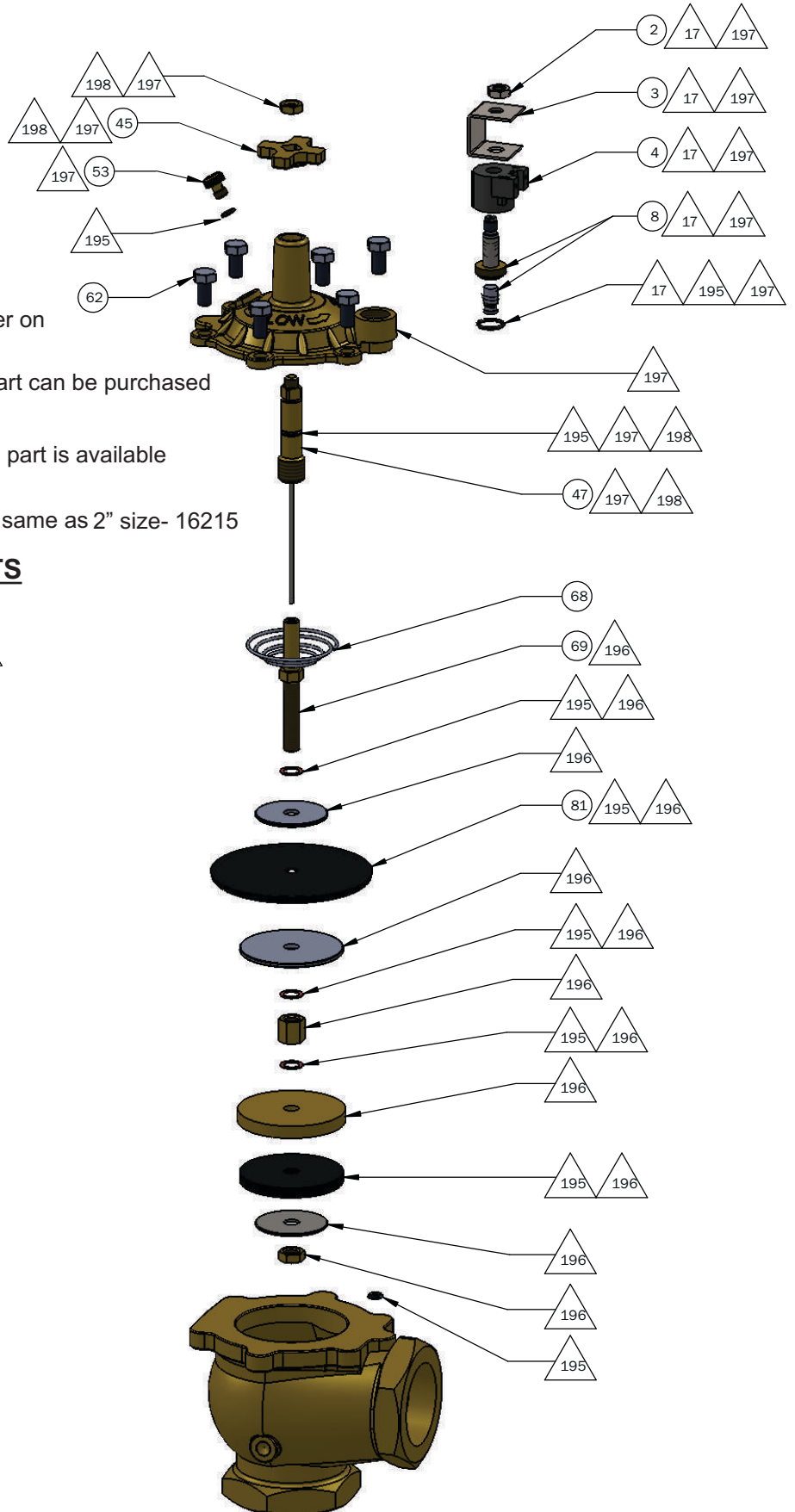



SUPERIOR

IN-LINE VALVES

Model 100

2" Model Depicted Below

NOTES:

1. Index numbers are listed in numerical order on reference guide in the back.
2. Circular index numbers indicate that the part can be purchased separately.
3. Triangular index numbers indicate that the part is available as part of a sub-assembly or repair kit.

SUB-ASSEMBLIES & REPAIR KITS

Repair Kits (all rubber & fiber parts) -  195

Diaphragm Assembly -  200

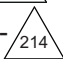
Flow Control Assembly -  214

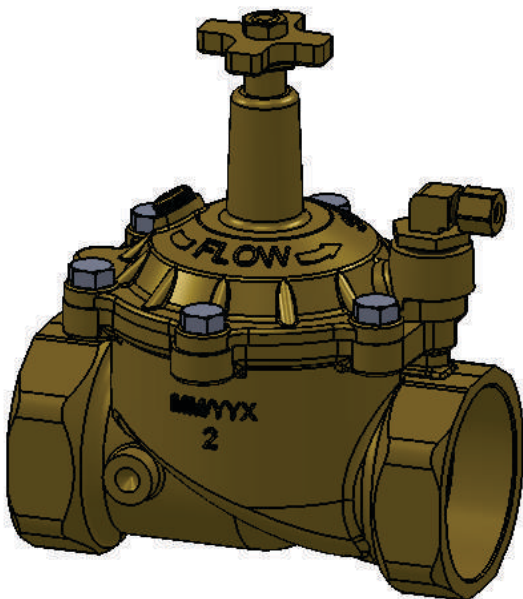
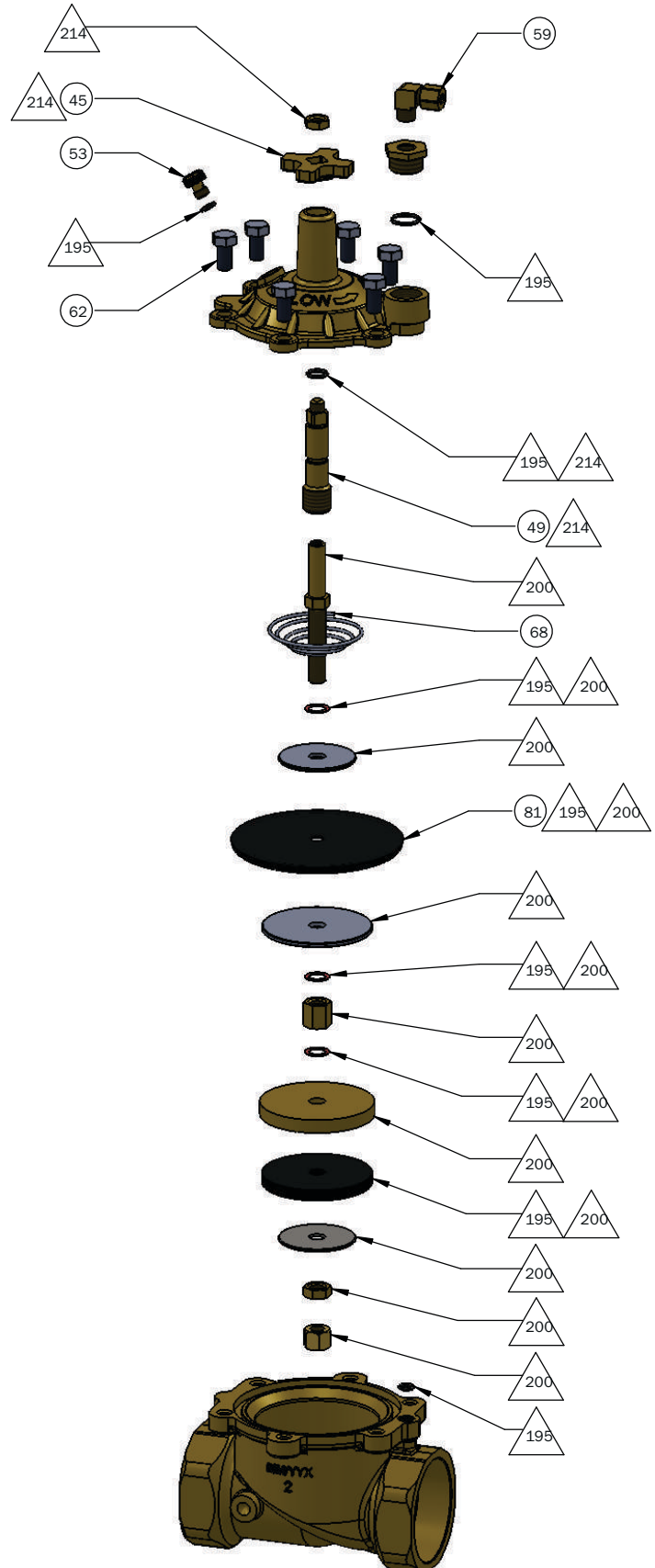



SUPERIOR

IN-LINE VALVES

Model 1000

2" Model Depicted Below

NOTES:

1. Index numbers are listed in numerical order on reference guide in the back.
2. Circular index numbers indicate that the part can be purchased separately.
3. Triangular index numbers indicate that the part is available as part of a sub-assembly or repair kit.

SUB-ASSEMBLIES & REPAIR KITS

Repair Kits (all rubber & fiber parts) - 237

Diaphragm Assembly - 203

Top Assembly - 235

Solenoid Assembly - 18

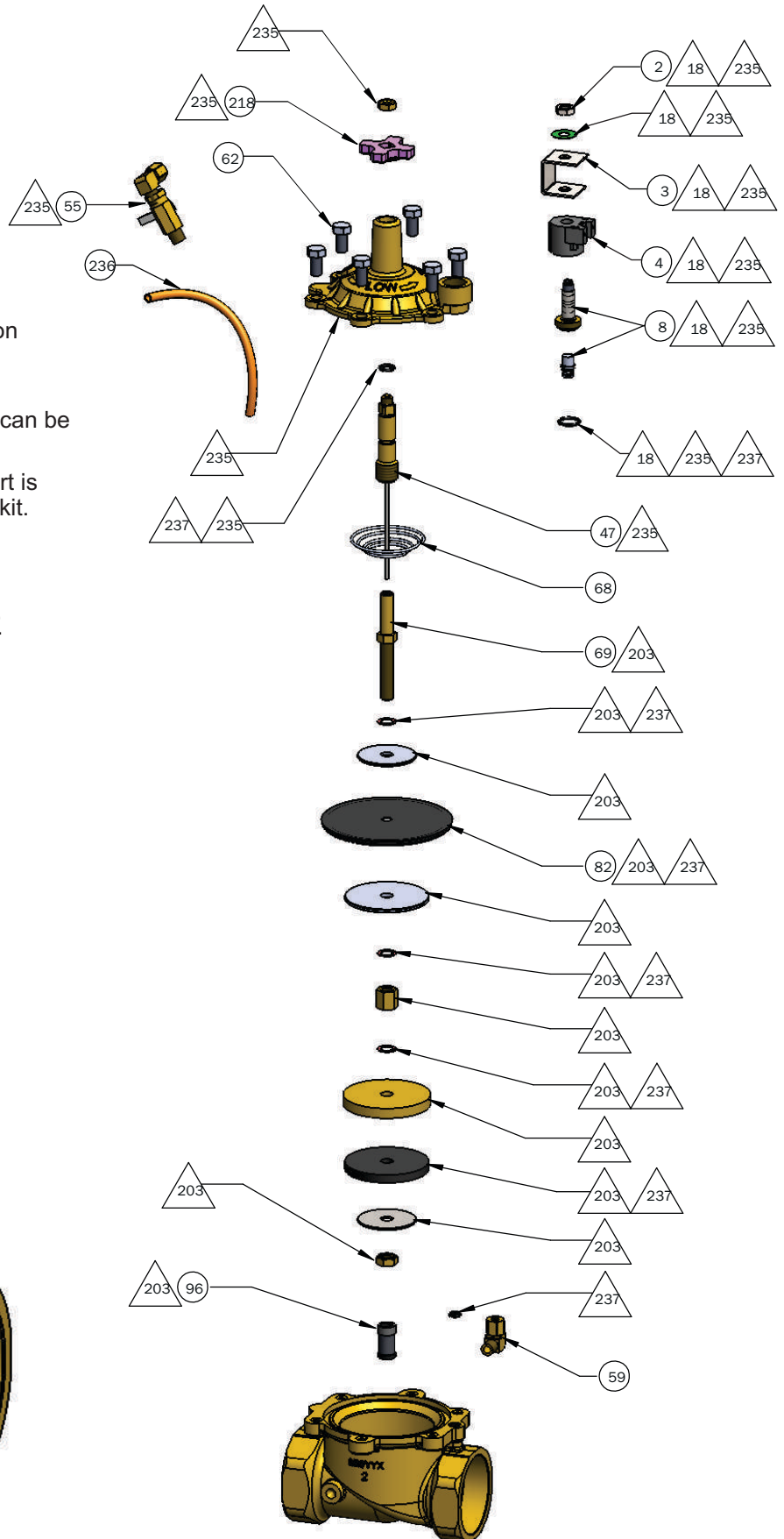
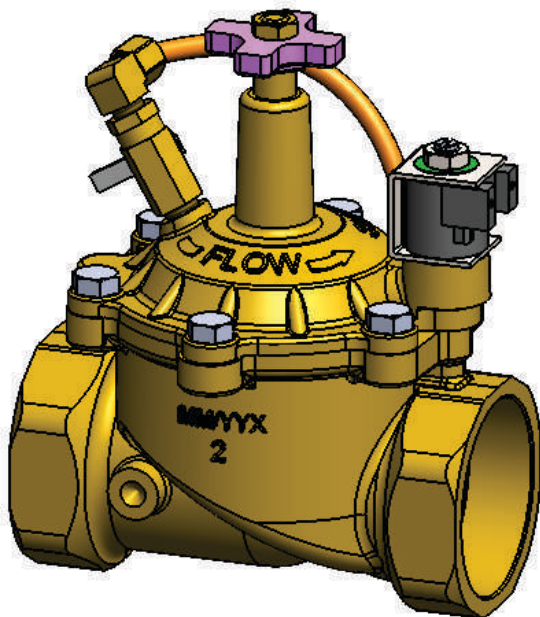



SUPERIOR

MASTER VALVES

Model 3000

2" Model Depicted Below

NOTES:

1. Index numbers are listed in numerical order on reference guide in the back.
2. Circular index numbers indicate that the part can be purchased separately.
3. Triangular index numbers indicate that the part is available as part of a sub-assembly or repair kit.

SUB-ASSEMBLIES & REPAIR KITS

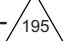
Repair Kits (all rubber & fiber parts) -  195

Diaphragm Assembly -  200

Flow Control Assembly -  214

Solenoid Assembly -  21

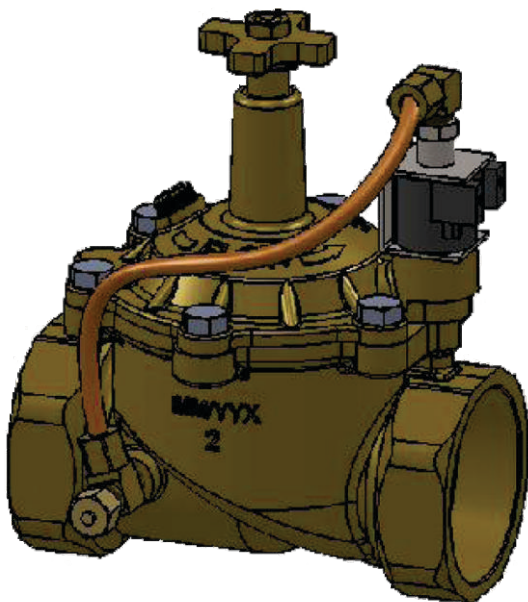
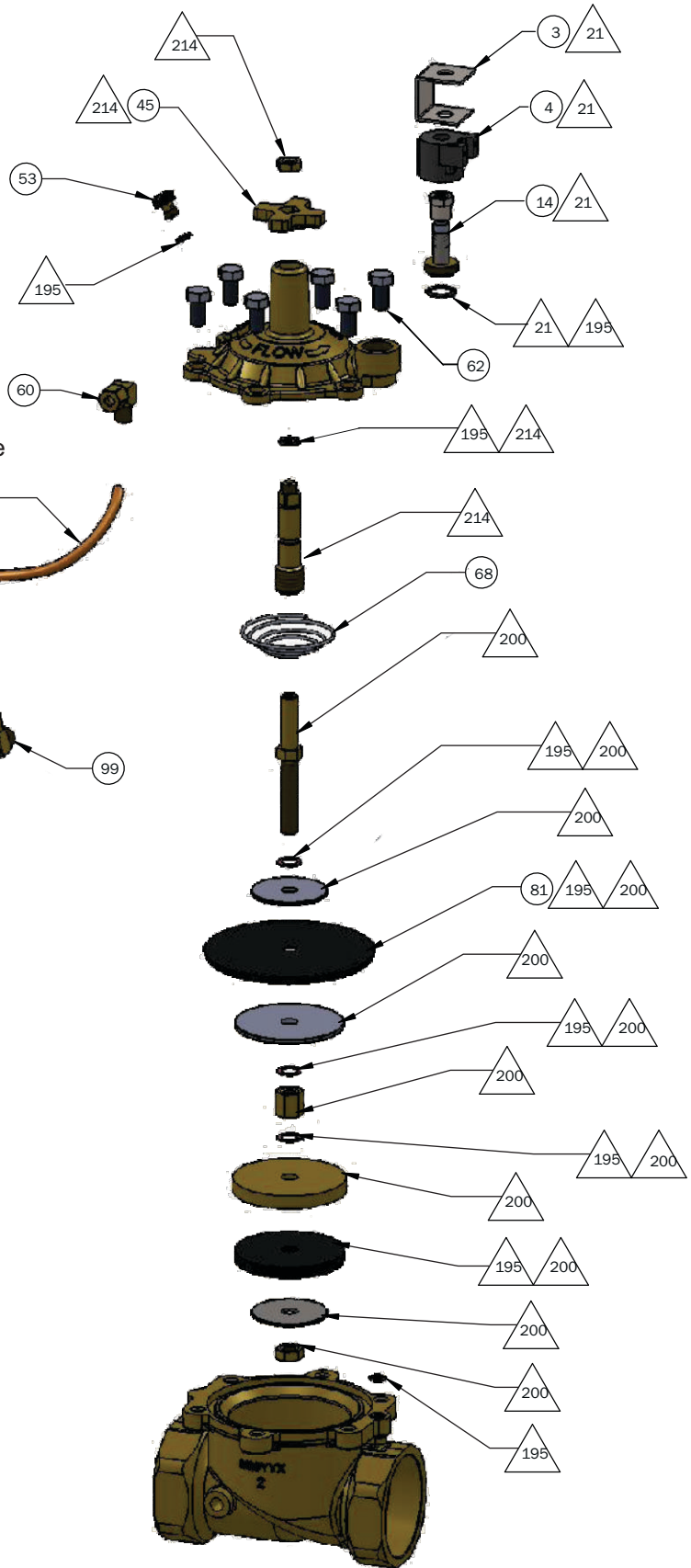



SUPERIOR

MASTER VALVES

Model 3100

2" Model Depicted Below

NOTES:

1. Index numbers are listed in numerical order on reference guide in the back.
2. Circular index numbers indicate that the part can be purchased separately.
3. Triangular index numbers indicate that the part is available as part of a sub-assembly or repair kit.

SUB-ASSEMBLIES & REPAIR KITS

Repair Kits (all rubber & fiber parts) - 195

Diaphragm Assembly - 196

Top Assembly - 212

Flow Control Assembly - 198

Solenoid Assembly - 20

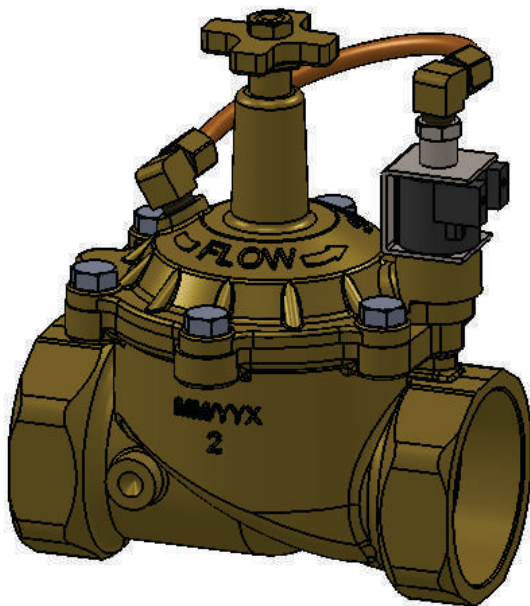
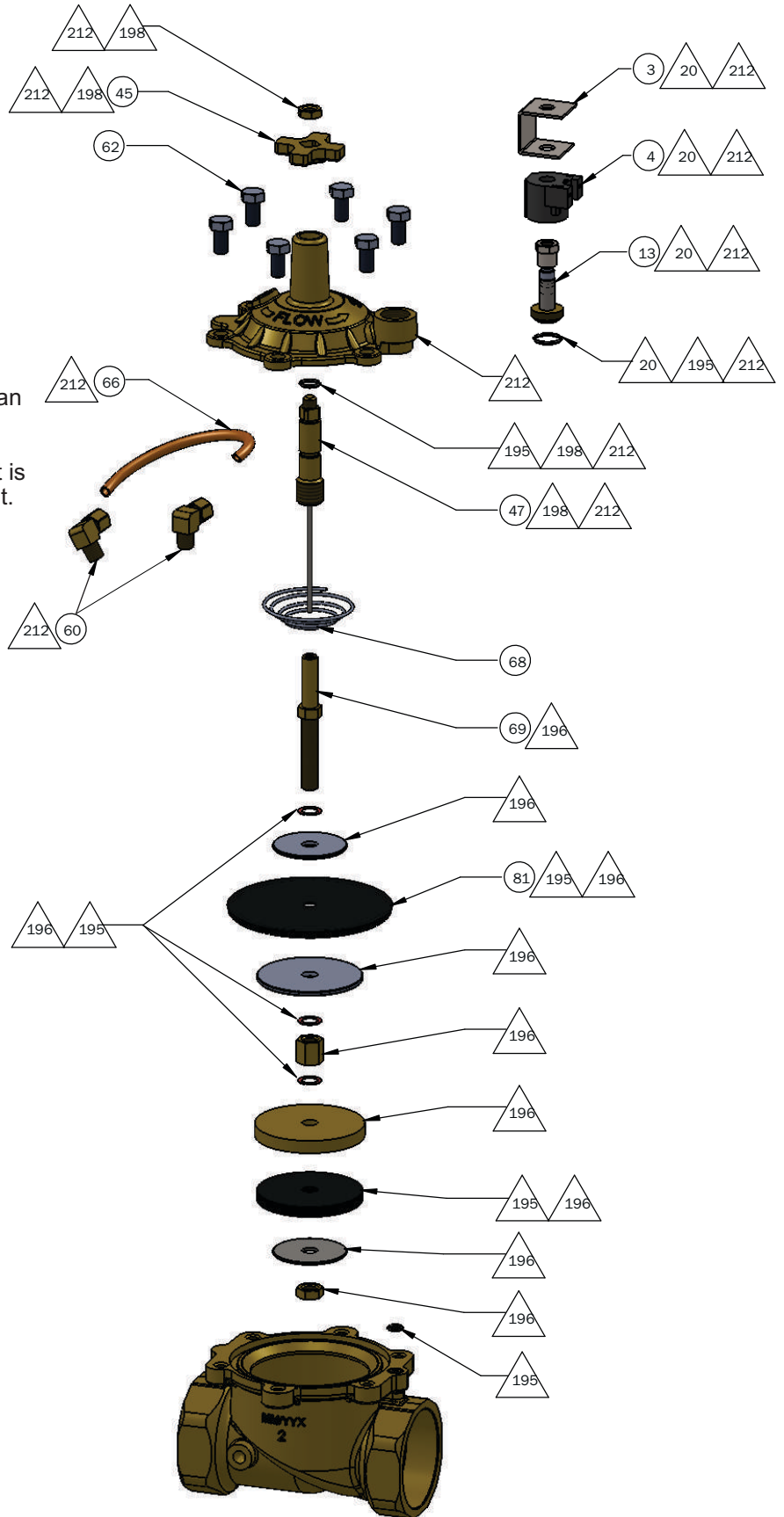



SUPERIOR

MASTER VALVES

Model 3100PRS

2" Model Depicted Below

NOTES:

1. Index numbers are listed in numerical order on reference guide in the back.
2. Circular index numbers indicate that the part can be purchased separately.
3. Triangular index numbers indicate that the part is available as part of a sub-assembly or repair kit.

SUB-ASSEMBLIES & REPAIR KITS

Repair Kits (all rubber & fiber parts) - 195

Diaphragm Assembly - 199

Top Assembly - 228

Flow Control Assembly - 198

Solenoid Assembly - 20

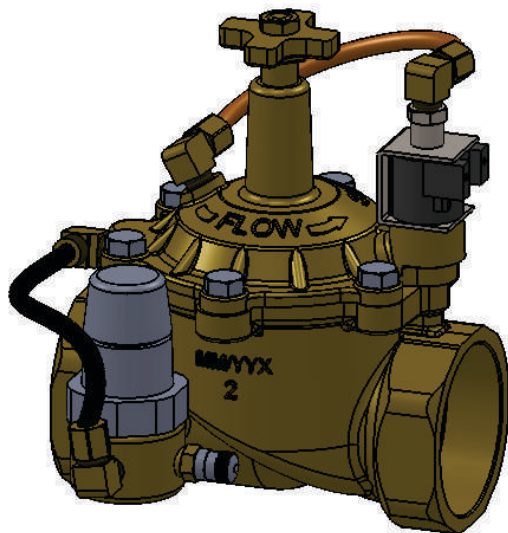
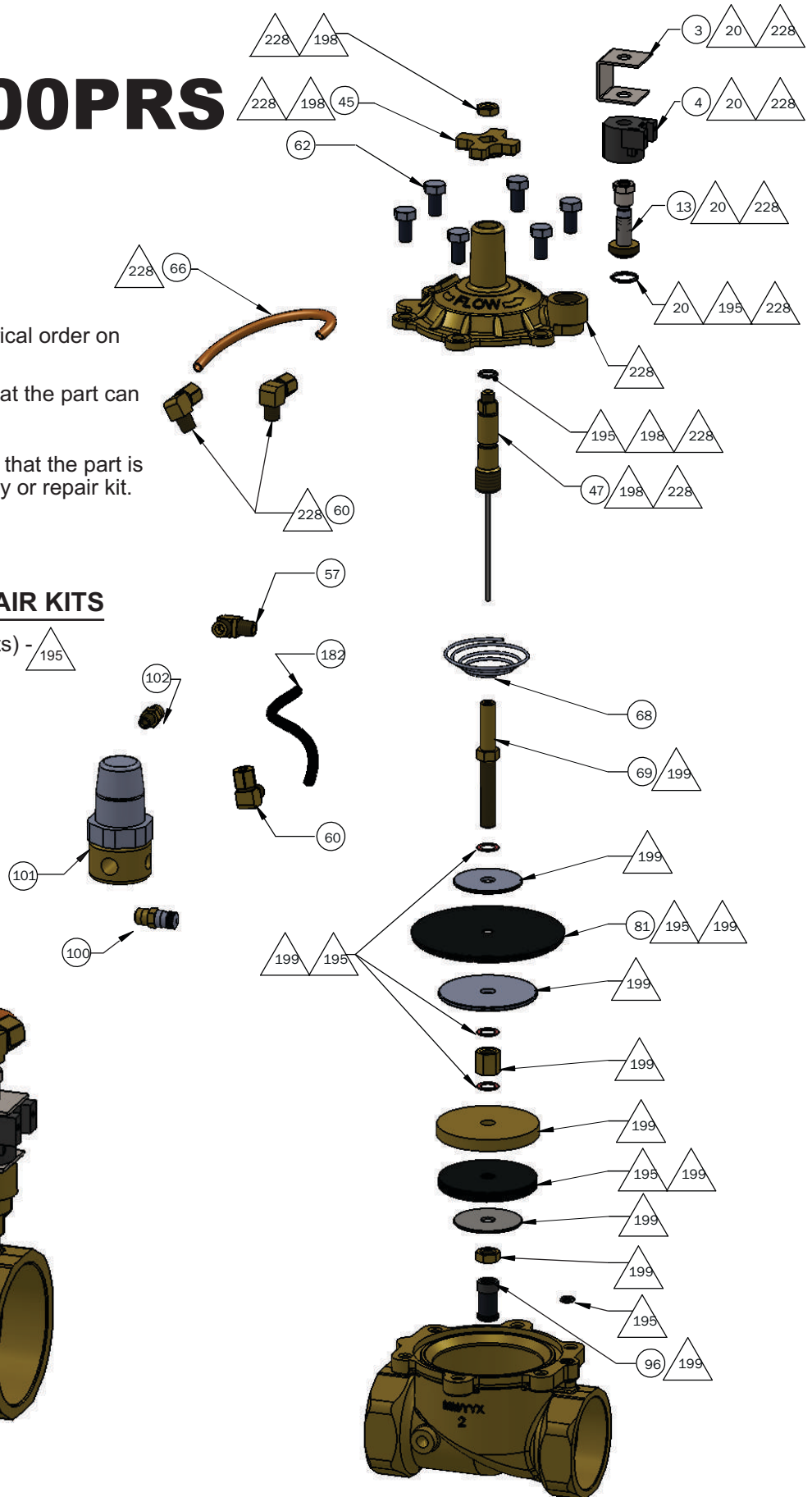



SUPERIOR

MASTER VALVES

Model 3200

2" Model Depicted Below

NOTES:

1. Index numbers are listed in numerical order on reference guide in the back.
2. Circular index numbers indicate that the part can be purchased separately.
3. Triangular index numbers indicate that the part is available as part of a sub-assembly or repair kit.

SUB-ASSEMBLIES & REPAIR KITS

Diaphragm and Chamber Plate Assembly -  225

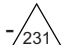
Top Assembly -  231

Flow Control Assembly -  214

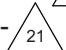
Solenoid Assembly -  21

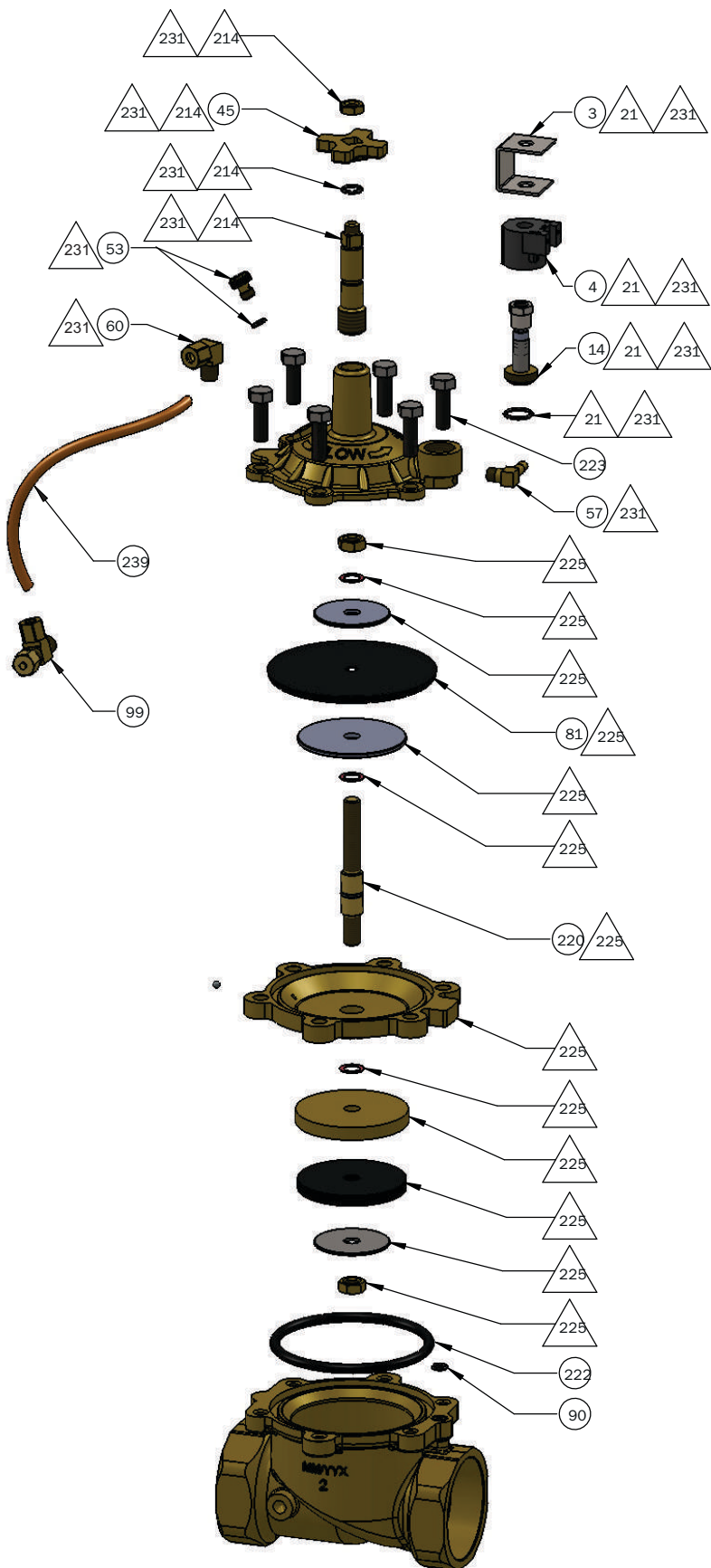
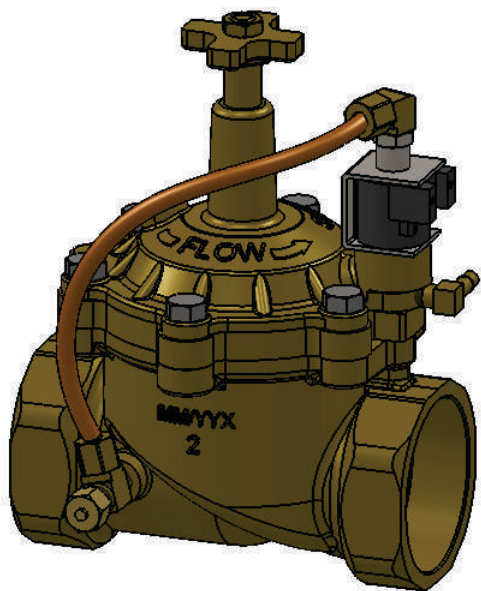



SUPERIOR

MASTER VALVES

Model 3300

2" Model Depicted Below

Notes:

1. Index numbers are listed in numerical order on reference guide in the back.
2. Circular index numbers indicate that the part can be purchased separately.
3. Triangular index numbers indicate that the part is available as part of a sub-assembly or repair kit.

SUB-ASSEMBLIES & REPAIR KITS

Diaphragm and Chamber Plate Assembly -  229

Top Assembly -  217

Flow Control Assembly -  198

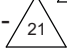
Solenoid Assembly -  21

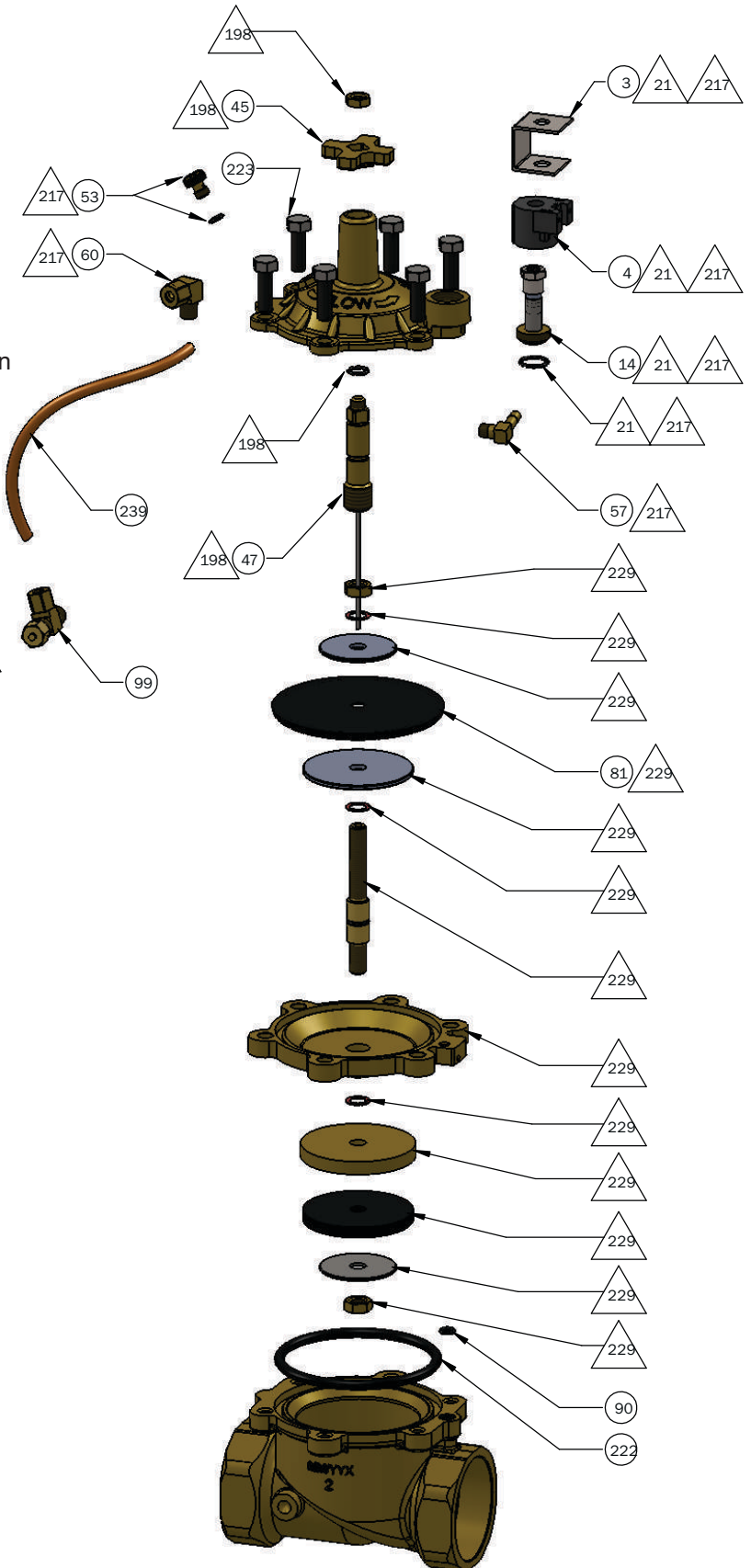
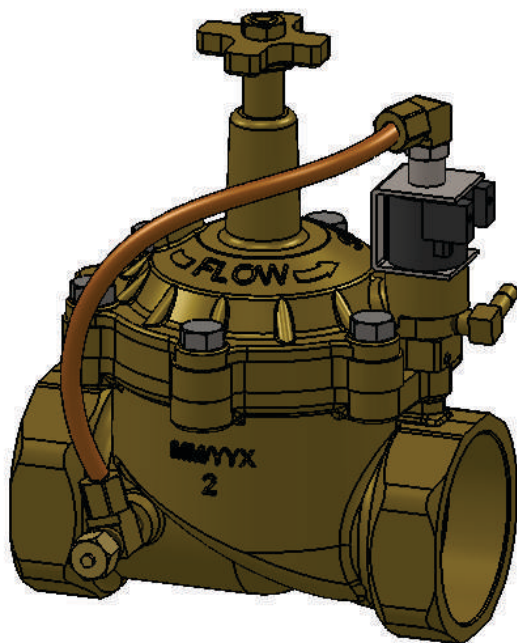



SUPERIOR

AUTOMATIC DRIP IRRIGATION VALVE

Model 850DI

1" Model Depicted Below

NOTES:

1. Index numbers are listed in numerical order on reference guide in the back.
2. Circular index numbers indicate that the part can be purchased separately.
3. Triangular index numbers indicate that the part is available as part of a sub-assembly or repair kit.

SUB-ASSEMBLIES & REPAIR KITS

Repair Kits (all rubber & fiber parts) - 

Solenoid Assembly - 

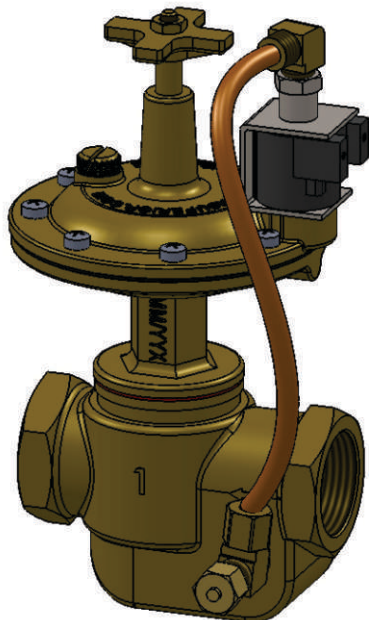
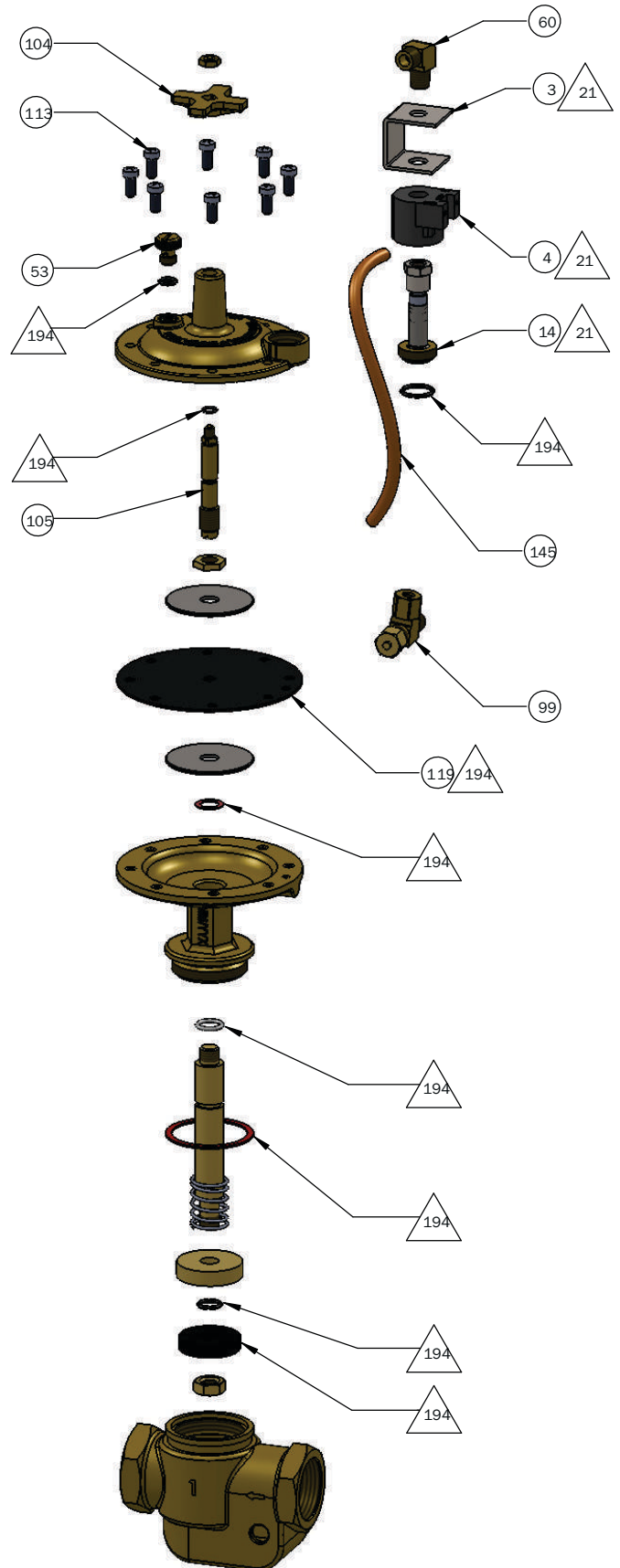



SUPERIOR

ADAPTORS

Model 800

3/4" Model Depicted Below

NOTES:

1. Index numbers are listed in numerical order on reference guide in the back.
2. Circular index numbers indicate that the part can be purchased separately.
3. Triangular index numbers indicate that the part is available as part of a sub-assembly or repair kit.

SUB-ASSEMBLIES & REPAIR KITS

Repair Kits (all rubber & fiber parts) -  184

Diaphragm Assembly -  186

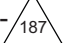
Top Assembly -  187

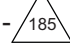
Flow Control Assembly -  185

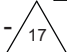
Solenoid Assembly -  17

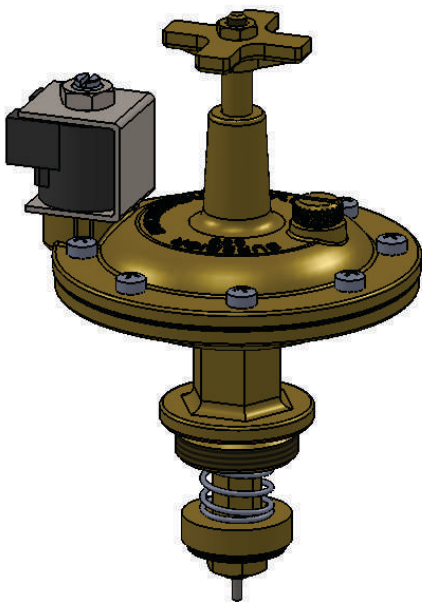
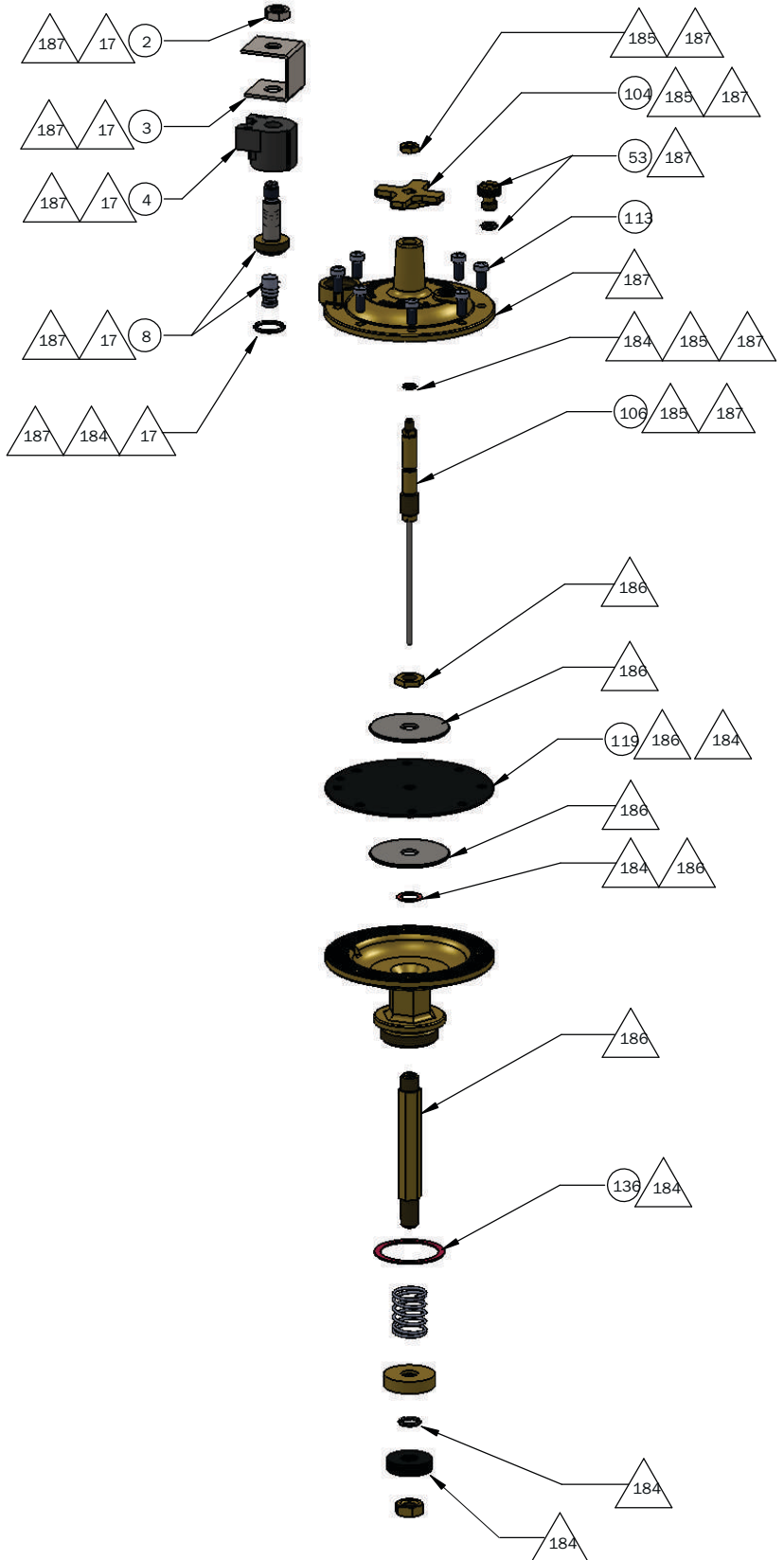



SUPERIOR

ADAPTORS

Model 2000

3/4" Model Depicted Below

Notes:

1. Index numbers are listed in numerical order on reference guide in the back.
2. Circular index numbers indicate that the part can be purchased separately.
3. Triangular index numbers indicate that the part is available as part of a sub-assembly or repair kit.

SUB-ASSEMBLIES & REPAIR KITS

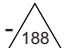
Repair Kits (all rubber & fiber parts) - 

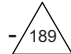
Diaphragm Assembly - 

Solenoid Assembly - 